

TEST ITEMS

Basic blood-gas	Haematology	Electrolyte	Biochemistry
pH, pCO ₂ , pO ₂	Hct	K ⁺ , Na ⁺ , Ca ⁺⁺ , Cl ⁻	Glu, Lac

CALCULATION PARAMETERS

Total 24 Parameters:

cH⁺, cH⁺(T), pH(T), pCO₂(T), pO₂(T), HCO₃⁻atd, HCO₃⁻std, BB(B), BE(B), BE(ecf), ct CO₂, Ca⁺⁺(7.4), AnGap, tHb(est), sO₂(est), pO₂(A-a), pO₂(A-a)(T), pO₂(a/A), pO₂(a/A)(T), RI, RI(T), pO₂/FI O₂, pO₂(T)/FI O₂, POP

TEST PACKAGES

Cat. No.	Test Item	Qualification
W459	pH, pCO ₂ , pO ₂	CE NMPA
W461	K ⁺ , Na ⁺ , Ca ⁺⁺ , Cl ⁻	CE NMPA
W465	pH, pCO ₂ , pO ₂ , K ⁺ , Na ⁺ , Cl ⁻ , Ca ⁺⁺ , Hct	CE NMPA
W466	pH, pCO ₂ , pO ₂ , K ⁺ , Na ⁺ , Cl ⁻ , Ca ⁺⁺ , Hct, Glu, Lac	CE NMPA

Wondfo

Guangzhou Wondfo Biotech Co., Ltd.

No. 8 Lizhishan Road, Science City, Huangpu District, 510700 Guangzhou, P.R.China
Tel: (+86) 400-830-8768 Website: en.wondfo.com.cn E-mail: sales@wondfo.com
Wondfo reserves all rights. All contents of this brochure are copyrighted by Wondfo.



Rev. A10 Rel.: 2022/11/04

Wondfo

Fight for time and grab treatment opportunity for critical patients whenever wherever!

Blood Gas Analyzer
• Reliable • Portable • Accurate • Efficient



BGA-102

CE NMPA

Guangzhou Wondfo Biotech Co., Ltd.

1 BENIFITS

Automatic Sampling Process

Without manual operation, the procedure is more simple.

Maintenance Free

Compact instrument design, no internal liquid path, no need for maintenance.

Accurate Results

Good correlation with the Radiometer and help doctors make a diagnosis.

Easy To Use

Only two steps are required to complete one sample test.

Carry With Ease

Small and light, humanized handle makes it easier to carry.



302(L)*226(W)*180(H) mm
No more than 6.5 kg
(including battery but no power adapter)

Design advantages make it adapt to different scenarios.



Battery powered



Built-in Printer



LIS Connect Function



Operate Video

Lorem ipsum

2 APPLICATION SCENARIOS

Necessary equipment for medical institutions to treat critically ill patients.



ICU/CCU/NICU



ER



OR



Pneumology Department



Ambulance

3 OPERATION

Two-steps operation, One complete test.

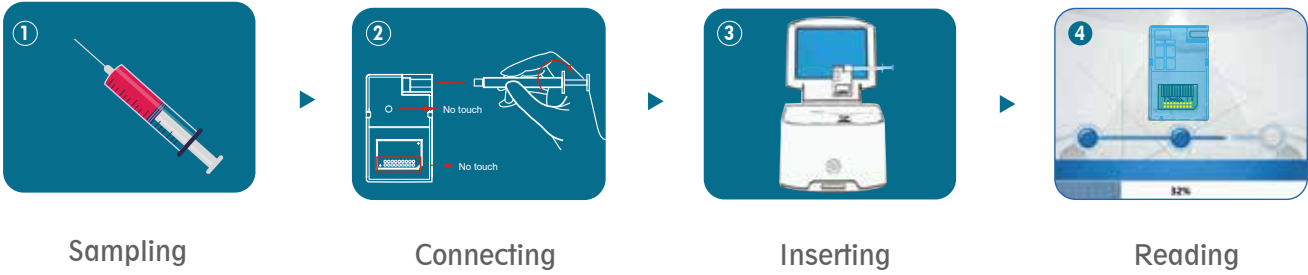

4 COMPONENTS

Less product component, better user experience.

Test Card		<p>One test card, multiple solutions.</p> <ul style="list-style-type: none">Sample Type: Arterial Whole BloodSample Volume: 80 μLTest Time: 45 sStore at room temperature for up to 12 months (for W466: up to 9 months)Suitable for syringe
Reagent Pack		<ul style="list-style-type: none">Storage Condition: 2~8°CShelf Life: 12 monthsInstalled Life:<ul style="list-style-type: none">10 parameters: 45 days8 parameters: 60 days
Quality Control		<ul style="list-style-type: none">3 levels quality control analysisExternal quality control